

Mould Seal Data Sheet: RD-20-0010

'D' section mould seal used as a resin seal in 'Light' RTM or RTM tooling. This can be inflated or collapsed under vacuum using a seal control unit (XE-0400).

General Specifications	
Silicone Type	General Purpose
Colour	White
Overall Height	14 mm
Overall Width	12 mm
Cross Sectional Area	109 mm ²
Shore Hardness	55 shore
Service Temperature	Continuous use: Maximum 180°C Single use: Maximum 200°C
Compressive Force	4.5 kN/m *to fully close mould seal on a metal RTM channel
Shelf Life	5-10 years *if stored correctly (HOW)
*All extrusion dimensions must be to Silicone Extrusion Tolerance Table E1	

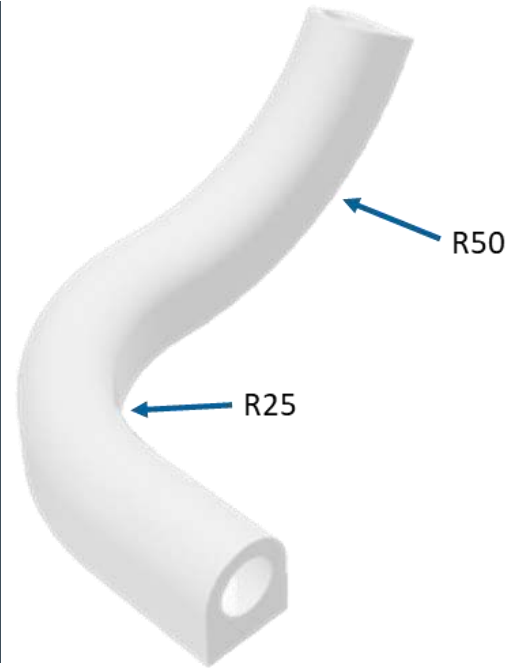

Groove Specifications

To avoid seal damage: Please ensure that the cross sectional area of the seal groove is approximately 10% larger than the area of seal being used. This applies to both composite and metal tooling.

Note: The largest practical bend radius, particularly in the vertical direction for the mould tooling is preferable.

Composite VRTM — Peripheral Fill

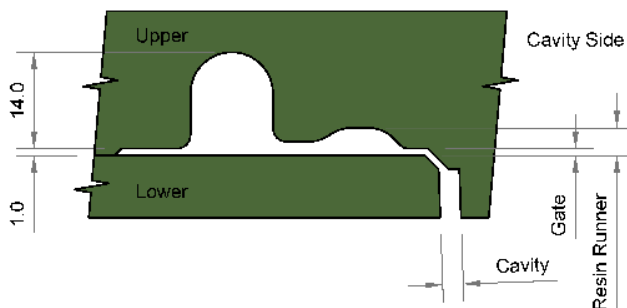

D seal groove to suit RD-20-0013 or RD-20-0011
Use RD-20-0010 (white) to form groove
Use RD-20-0016 (red) to form resin runner
Blend edge of groove R2 Typ

Metal RTM

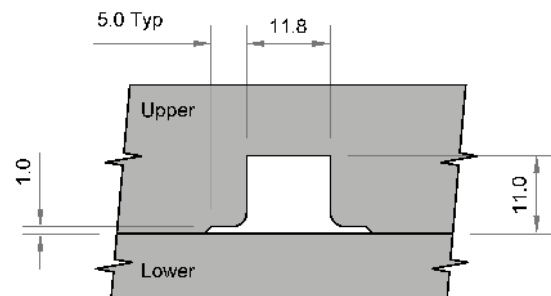

D seal groove to suit:
RD-20-0010 (white)
RD-20-0011 (green)
RD-20-0013 (blue)
Runner detail varies on application

